

BARTLETT & COOKE

INDEPENDENT ESTATE AGENTS

WALTON ON THE HILL KT20 7UF



- **END OF TERRACE HOUSE**
- **SITTING ROOM**
- **RECEPTION HALL**
- **SOUTHERLY BACKING GARDEN**
- **VILLAGE LOCATION**
- **THREE GOOD SIZE BEDROOMS**
- **KITCHEN-BREAKFAST ROOM**
- **DOUBLE GLAZED**
- **GAS CENTRAL HEATING**
- **OFF STREET PARKING**

Price: £315,000 Freehold

Walton On The Hill Surrey, KT20 7UF



An extended and refurbished three bedroom end of terrace property situated within a sought after village cul-de-sac. Offering spacious accommodation throughout the property comprises: Reception hall/dining room, sitting room with oak flooring, fitted kitchen-breakfast room. Three good size bedrooms and modern bathroom. The southerly backing rear garden extends to in excess of 90ft and has large patio area, pond and two sheds. There is off street parking to the front. A deceptively spacious property, which must be viewed internally to appreciate.



Walton On The Hill, KT20 7UF

Ground Floor

Approx. 41.6 sq. metres (447.3 sq. feet)

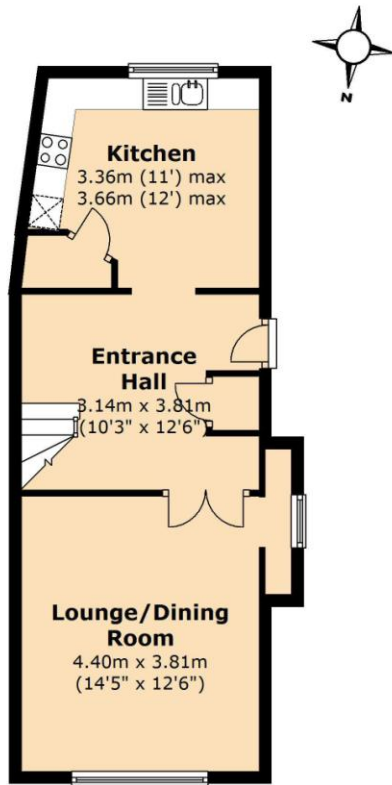

First Floor

Approx. 35.5 sq. metres (382.1 sq. feet)

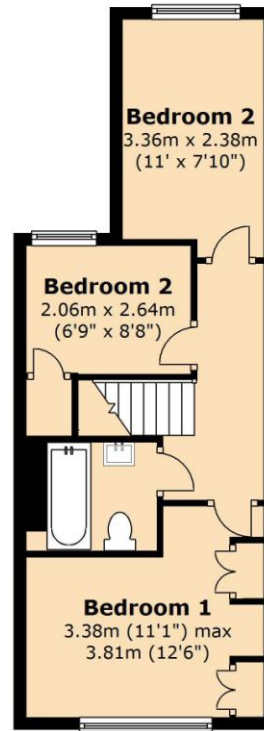

Total area: approx. 77.1 sq. metres (829.4 sq. feet)

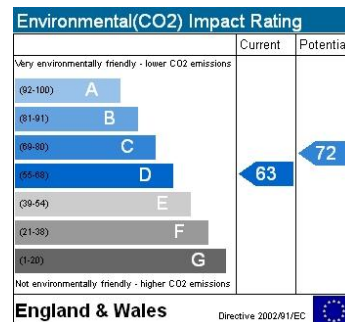
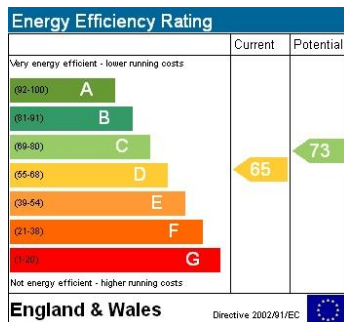

IMPORTANT NOTE; These particulars are intended as a guide and do not form part of any contract. Please check with us any detail which is important to you, particularly if you intend to view the property. We have not checked or tested any service, system, (whether heating, plumbing, electrical etc) appliance, fixture or fitting that may be included with this property. We advise any prospective purchasers to satisfy themselves as to their condition.