

# BARTLETT & COOKE

INDEPENDENT ESTATE AGENTS

## WATERER GARDENS TADWORTH KT20 5PB



- Carriage driveway
- Fully double glazed
- Detached bungalow
- Dining room / bedroom
- Popular location
- Single garage
- No chain
- Beautifully presented
- Fitted kitchen
- Attractive gardens

**Price: £449,950 Freehold**

Waterer Gardens Tadworth KT20 5PB



**A BEAUTIFULLY PRESENTED AND  
MUCH IMPROVED DETACHED BUNGALOW.**

Located in a convenient and popular close within walking distance of Asda supermarket as well as local shops at nearby Burgh Heath. Accommodation and features include: Entrance porch, spacious hallway, main bedroom with fitted wardrobes, guest double bedroom, dining room/bedroom 2, large sitting room with additional sun room to rear, fitted kitchen, luxury fully tiled shower room, loft hobbies space with pull down ladder, attractive lawned rear garden, single garage with moulded paved style carriage driveway. double glazing & gas central heating. The property has no onward chain and viewing is highly recommended



# Waterer Gardens Tadworth KT20 5PB

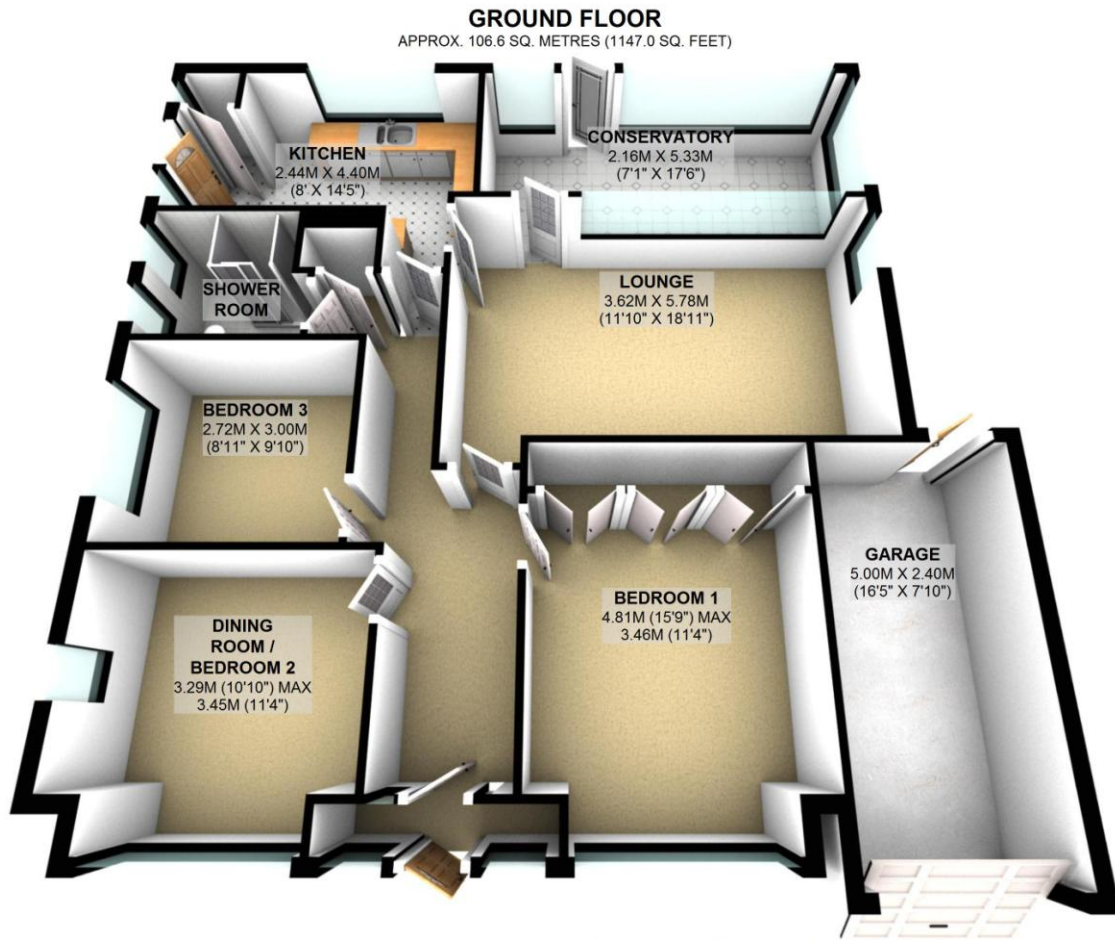

TOTAL AREA: APPROX. 106.6 SQ. METRES (1147.0 SQ. FEET)

This floor plan is not to scale. They are for guidance only and accuracy is not guaranteed. Plan produced by PRS.

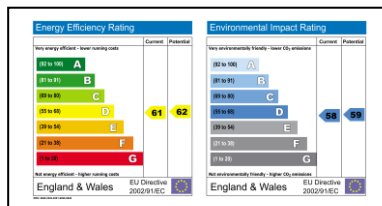

**IMPORTANT NOTE;** These particulars are intended as a guide and do not form part of any contract. Please check with us any detail which is important to you, particularly if you intend to view the property. We have not checked or tested any service, system, (whether heating, plumbing, electrical etc) appliance, fixture or fitting that may be included with this property. We advise any prospective purchasers to satisfy themselves as to their condition.